



# CROWN VIEW

• GREAT ELLINGHAM •

SHARED OWNERSHIP



Computer generated image

## THE HAWTHORNE

### 2 Bedroom Semi-Detached House

Plots 3, 4, 5, 26, 27, 28 & 29

#### GROUND FLOOR

Living/Dining Room	4.91m x 3.87m	16'1" x 12'8"
Kitchen	4.34m x 2.52m	14'3" x 8'3"

#### FIRST FLOOR

Primary Bedroom	3.73m x 3.27m	12'3" x 10'9"
Bedroom 2	4.91m x 2.67m	16'1" x 8'9"



01603 255444  
sharedownership@flagship-homes.co.uk  
flagship-homes.co.uk



# CROWN VIEW

• GREAT ELLINGHAM •

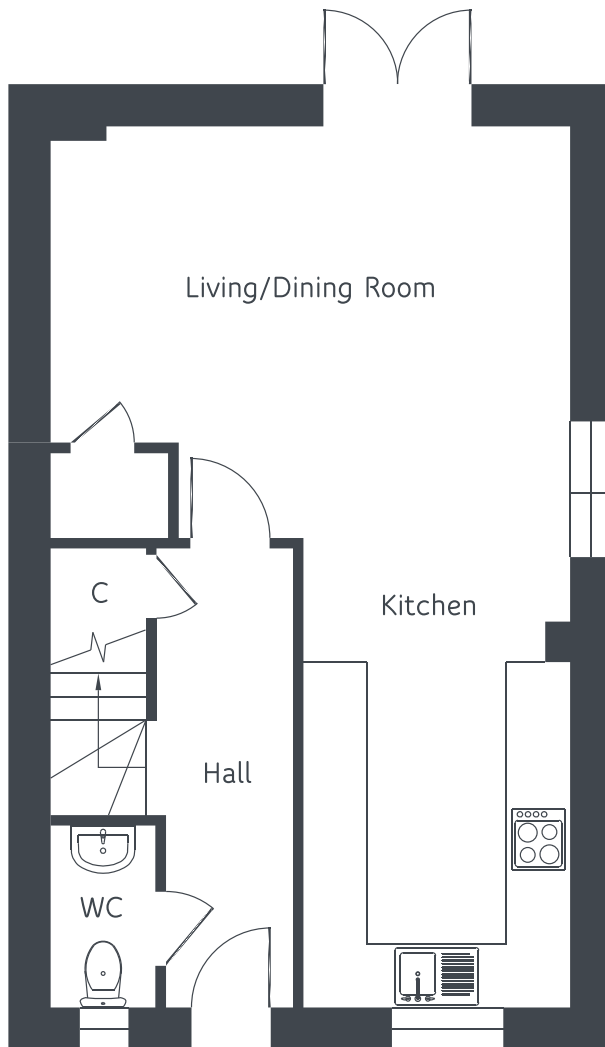

GROUND FLOOR

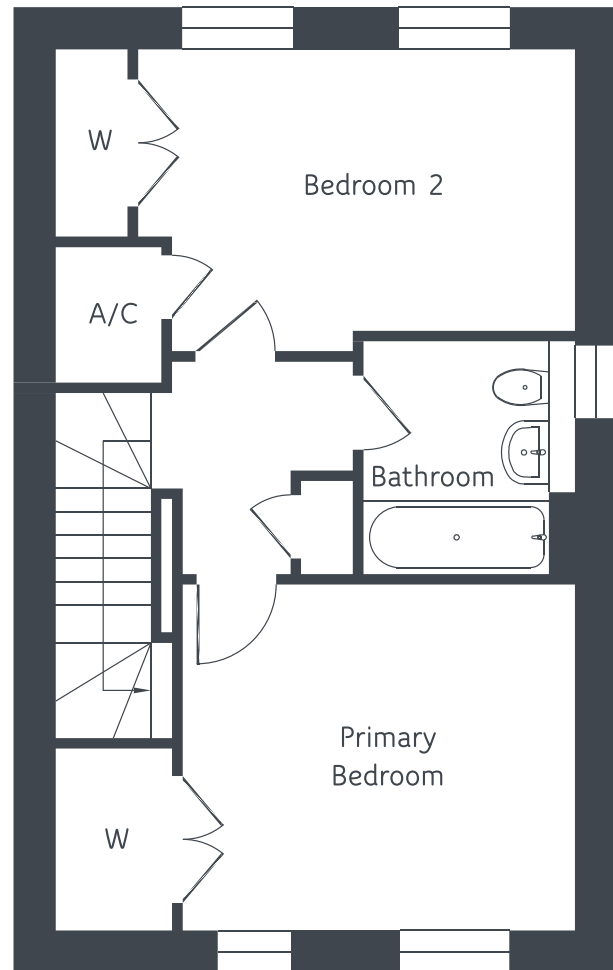

FIRST FLOOR

**Total floor space: 856 sq ft / 79.70 sq m**

Floor plans and computer generated images are indicative only and external finished may vary. Dimensions shown may vary within a tolerance of +/- 50mm and are not intended to be used for carpet sizes, appliance sizes or items of furniture. Floor plans are not shown to scale.