

The Claydon

3 Bedroom Semi-Detached House



Computer generated image of The Claydon
All cars are for illustrative purposes only and may be subject to change. Please see our Data Protection notice for more information.

Plots

Shared Ownership: 43 & 44.

The Claydon has been thoughtfully designed to create the perfect family home, with three bedrooms and a family bathroom on the first floor. The ground floor comprises of a well-equipped kitchen/dining room and a substantial living area, great for entertaining guests.

Ground floor

Kitchen/Dining Room	4.15M X 3.51M	13'7" X 11'6"
Living Room	4.87M X 4.00M	16'0" X 13'1"

First floor

Principal Bedroom	4.29M X 2.85M	14'0" X 9'4"
Bedroom 2	4.73M X 2.86M	15'6" X 9'4"
Bedroom 3	3.47M X 2.20M	11'4" X 7'2"
Bathroom	2.20M X 1.97M	7'2" X 6'5"



Ground floor

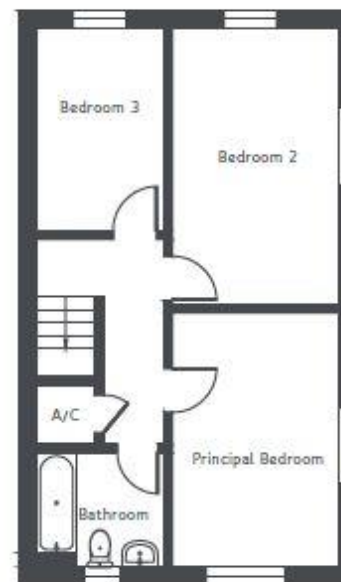

First floor

Total Floor Space: 93.8sq.m. | 1008sq.ft.

Floor plans and computer generated images are indicative only and external finishes may vary. Please refer to the drawings in the Marketing Suite. Dimensions shown may vary within a tolerance of +/- 50mm and are not intended to be used for carpet sizes, appliance sizes or items of furniture. Floor plans are not shown to scale.

Shared ownership